

Information on this print is of
proprietary nature and is not
to be copied. This design is
the property of Sauber Mfg. Co.

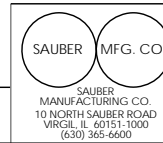

SAUBER MFG. CO. VIRGIL, IL	
TITLE	
AL-Plat Platform Sales Assembly w/ Fold-Down Racks - S14496G	
IDENT. NO.	REV.
S2051SAL	R02
SCALE: 1:48	DRAWN: DATE: 6/29/2011 SHEET 1 OF 3

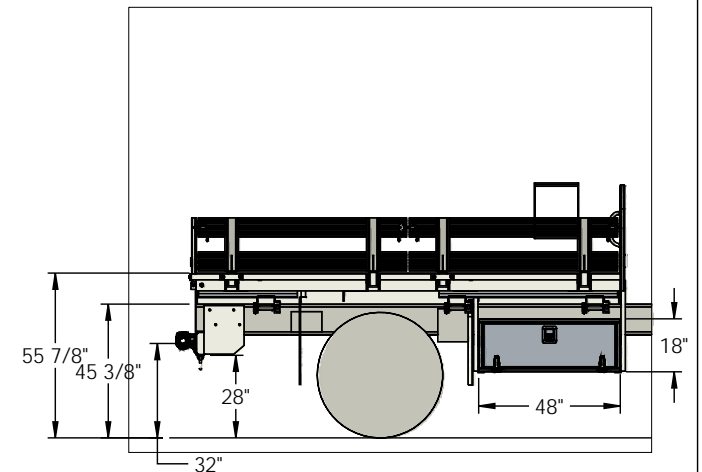
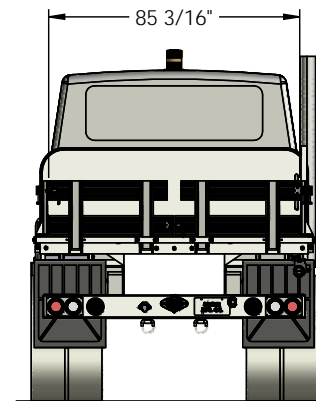
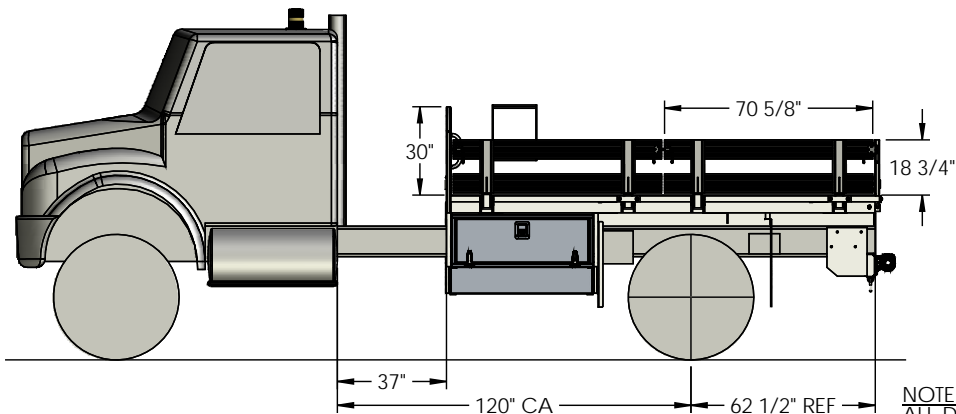
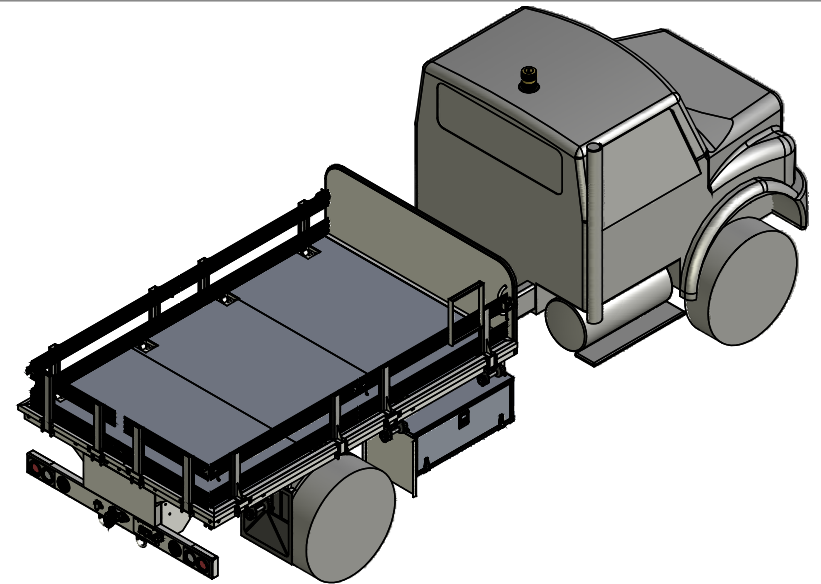
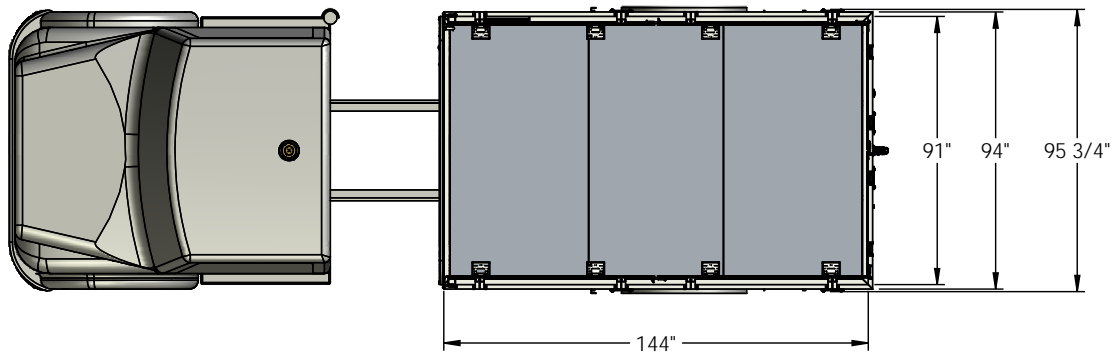

NOTE:
ALL DIMENSIONS TO GROUND SUBJECT TO
ACTUAL CHASSIS HEIGHT.

WORKSTAR 7300 4X4
SHOWN IN UNLOADED CONDITION. FULL LOAD
HEIGHT IS 4.2" LOWER THAN SHOWN.

Information on this print is of
proprietary nature and is not
to be copied. This design is
the property of Sauber Mfg. Co.

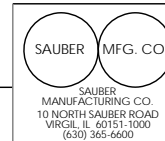

SAUBER MFG. CO. VIRGIL, IL	
TITLE AL-Plat Platform Sales Assembly w/ Fold-Down Racks - S14496G	
IDENT. NO. S2051SAL	REV. R02
SCALE: 1:48	DRAWN: DATE: 6/29/2011 SHEET 2 OF 3

SHOWN WITH RACKS FOLDED DOWN

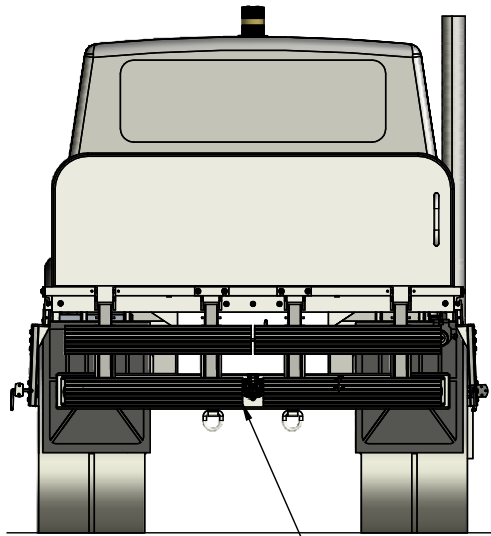

RACKS TRIMMED FOR
HITCH CLEARANCE

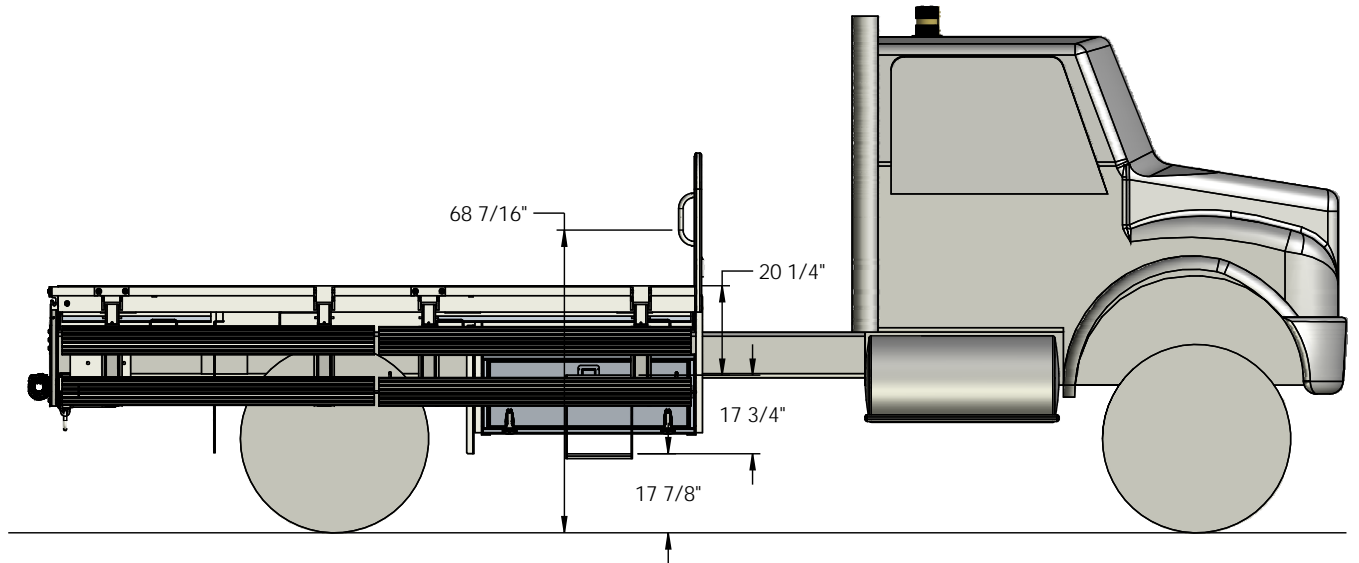

NOTE:
ALL DIMENSIONS TO GROUND SUBJECT TO
ACTUAL CHASSIS HEIGHT.

WORKSTAR 7300 4X4
SHOWN IN UNLOADED CONDITION. FULL LOAD
HEIGHT IS 4.2" LOWER THAN SHOWN.

Information on this print is of
proprietary nature and is not
to be copied. This design is
the property of Sauber Mfg. Co.

<div> <div>SAUBER</div> <div>MFG. CO.</div> </div> <div> SAUBER MANUFACTURING CO. 10 NORTH SAUBER ROAD VIRGIL, IL 60151-1000 (630) 365-6600 </div>	<div> SAUBER MFG. CO. VIRGIL, IL </div> <div> TITLE AL-Plat Platform Sales Assembly w/ Fold-Down Racks - S14496G </div> <div> IDENT. NO. S2051SAL </div> <div> SCALE: 1/4" = 1' DRAWN: DATE: 6/29/2011 SHEET 3 OF 3 </div>
--	--

REV.
R02